

Valvola OVERCENTER semplice effetto con pilotaggio esterno
Single OVERCENTER valve with external pilot
mod. OVC - SE

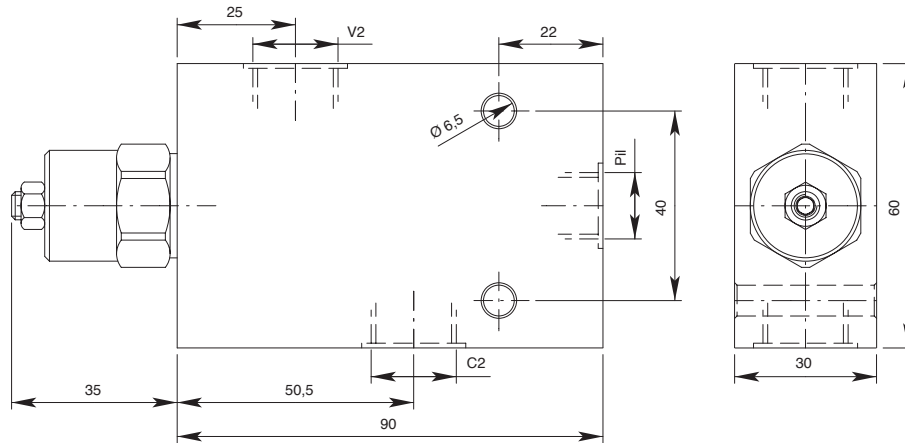
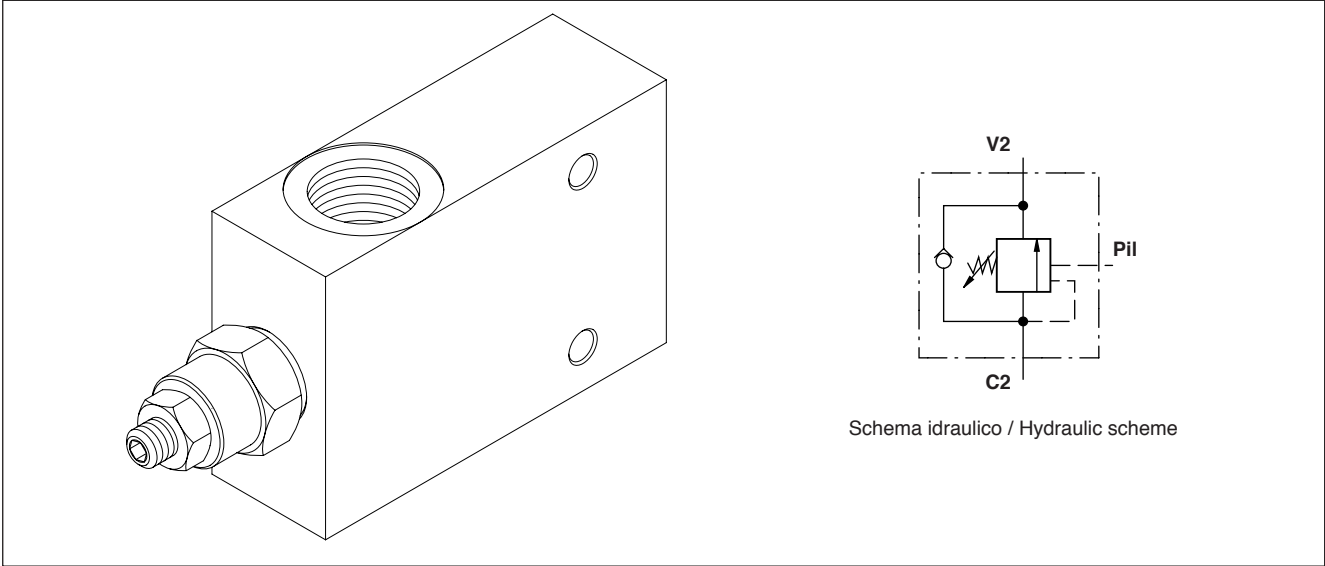

Modello Type	V2 C2	P11	Portata max Max flow l / min	Rapporto pilotaggio Pilot ratio	Pressione massima Max pressure bar
OVC-SE-38	3/8" gas	1/4" gas	40	4,25/1	350
OVC-SE-12	1/2" gas	1/4" gas	60		

A richiesta rapporti di pilotaggio 3/1, 8/1 e 10/1. Pilot ratios 3/1, 8/1 and 10/1 on request.

Tutti i dati forniti sono stati ottenuti usando olio con viscosità di circa 30cSt a 50°C. Campo di temperatura ammesso: -20°C, +90°C. Filtrazione assoluta: 25µ. I dati non sono impegnativi, CBF si riserva di apportare modifiche senza preavviso.

All performances and calibrations are carried out by using hydraulic oil with viscosity approx. 30cSt at 50°C. Temperature range: -20°C, +90°C. Filtration absolute: 25µ. The specifications are not binding, CBF reserves the right to introduce modifications without notice.

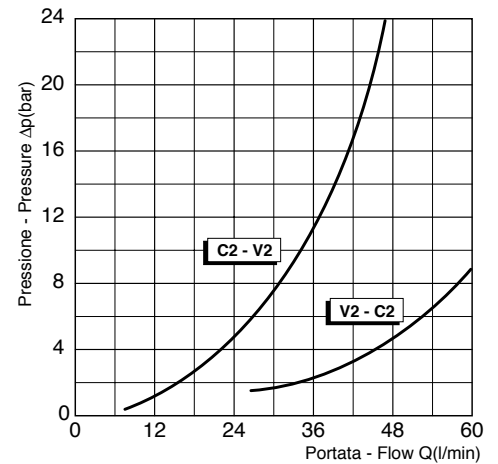

Sigla di ordinazione / Ordering code

OVC-SE-38 - 01

Modello / Type

Codice Molle: **01, 02**
Spring code: **01, 02**

Molle - Springs			
Codice Code	Taratura standard Standard setting bar (Q=5 l/min)	Campo di taratura Adj. pressure range bar	Colore Colour
01	100	20 ÷ 200	Bianco / White
02	280	50 ÷ 350	Nero / Black