



SPLINED SHAFTING & NIB SHAFTS FOR HYDRAULICS, OFF-ROAD & AGRICULTURAL

SPLINED HUBS,
COUPLINGS & SHAFTS

STANDARD SPLINED SHAFTING



Splined shafting is hobbled for the full listed length. In some instances undercut chucking registers may be present at one end. A centre is provided at one end. Material is K1045 Carbon steel. Finish is black "Colorsol". Imperial involute splines are to ANSI B92.1-1970. Pressure angles on all involute splines listed are 30 degrees. Spline OD* as listed for shafting, stubwelds and nibs is the form diameter. Actual major diameter may be smaller than form diameter by the form clearance for the subject spline. Straight sided splines are all to SAE standard.

Number of Teeth	Nom Spline O.D.	Specifications of Spline	Origin or Standard	Shaft Length	Known uses for this Hub	Part Number
6	1"	STRAIGHT SAE	IMP	8"	MOBILE EQUIP	470005S
6	1"	STRAIGHT SAE	IMP	10"	MOBILE EQUIP	9470005
6	1 1/8"	STRAIGHT SAE	IMP	10"	AGRICULTURE	94700102
6	1 1/4"	STRAIGHT SAE	IMP	8"	MOBILE EQUIP	9470082
6	34mm	34 x 28	DIN 5463	8"	AGRICULTURE	94700114
6	1 3/8"	STRAIGHT SAE	IMP	8"	AGRICULTURE	9470033
6	1 1/2"	STRAIGHT SAE	IMP	10"	MOBILE EQUIP	94700104
6	1 5/8"	STRAIGHT SAE	IMP	8"	MOBILE EQUIP	94700105
6	1 3/4"	STRAIGHT SAE	IMP	8"	MOBILE EQUIP	9470083
9	5/8"	16/32 DP INV 30PA	IMP. ANSI	6"	HYD. SAE A	9470001
10	1 1/4"	STRAIGHT SAE	IMP	10"	MOBILE EQUIP	94700110
10	1 3/4"	STRAIGHT SAE	IMP	8"	MOBILE EQUIP	9470081
11	3/4"	16/32 DP INV 30PA	IMP. ANSI	6"	HYD. SAE AH	9470002
13	7/8"	16/32 DP INV 30PA	IMP. ANSI	6"	HYD. SAE B	9470003
13	1 3/4"	8/16 DP INV 30PA	IMP. ANSI	8"	HYD. SAE D/E	9470008
14	1 1/4"	12/24 DP INV 30PA	IMP	8"	HYD.SAE C	9470006
14	1 1/4"	12/24 DP INV 30PA	IMP	11"	HYD.SAE C	9470006LL # New!!
15	1"	16/32 DP INV 30PA	IMP. ANSI	8"	HYD. SAE BB	9470004
16	35mm	2 MODULE INV W35	DIN 5480	203mm	HYD. REXROTH	9470011
16	1.7"	10/20 DP INV 30PA	IMP. ANSI	8"	GENERAL	9470039
16	2 1/8"	8/16 DP INV 30PA	IMP. ANSI	8"	GENERAL	9470040
17	1 1/2"	12/24 DP INV 30PA	IMP. ANSI	8"	GENERAL	9470032
18	35mm	A35 x 31	DIN 5482	203mm	GENERAL	9470021
20	1 3/4"	12/24 DP INV 30PA	IMP. ANSI	8"	AGRICULTURE	94700113
21	1 3/8"	16/32 DP INV 30PA	IMP. ANSI	8"	AGRICULTURE	9470007
23	1 1/2"	16/32 DP INV 30PA	IMP. ANSI	8"	HYD.SUND	9470043
24	50mm	2 MODULE INV W50	DIN 5480	203mm	HYD. REXROTH	9470045
26	2 1/4"	12/24 DP INV 30PA	IMP. ANSI	8"	GENERAL	9470048
27	1 3/4"	16/32 DP INV 30PA	IMP. ANSI	8"	AGRICULTURE	9470009
40	2 9/16"	16/32 DP INV 30PA	IMP. ANSI	8"	HYD.SUND	9470049

SPLINED FLOATING NIB SHAFTS

Long spline area for telescoping drives or transfer drive applications. Keyed shaft end for drive attachment.
Use with our standard splined hubs or splined couplings.

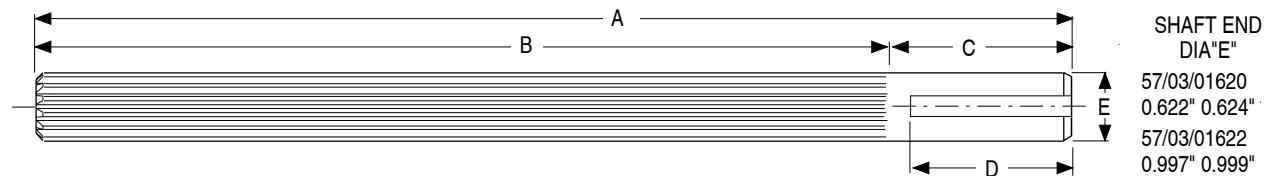

Part Number	A	B	C	D	Spline OD*	Key	No Of teeth	DP	Mating Cplgs	Mating Hubs
57/03/01620	470	410	60	40	0.625"	0.187"	9	16/32	94/60001	94/50001
57/03/01622	410	350	60	40	1.000"	0.250"	15	16/32	94/60004	94/50004