

HC-RCP foot pedal 2 service ports with side ports and reduced body height



**Technical specifications**

Max pressure: **100 bar**

Oil capacity: **12 l/min**

Weight: **3,4 Kg**

**Applications**

Mini-excavators

Hydraulic remote control HC-RCP belongs to the wide range of Hydrocontrol S.p.A. This Pedal is characterized by reduced overall dimensions and several configurations. HC-RCP works according to the principle of direct-acting pressure reducing valves. In rest position, the foot pedal is held in neutral by return spring; inlet port P is closed and ports are connected to tank port T.

**Dimensions**

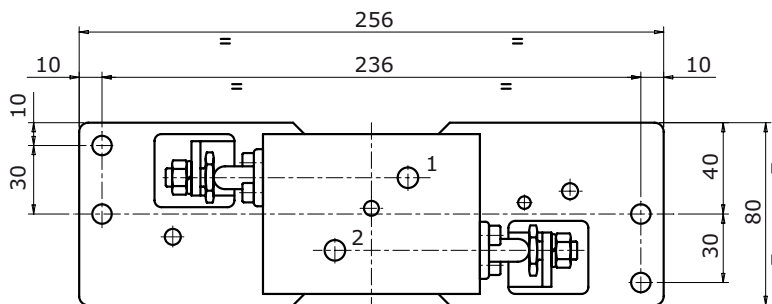

HYDRAULIC SCHEMA

