

# BG30 GR. 3

FLANGIA SAE B **S20** / SAE B-OR **S21**  
SAE B **S20** / SAE B-OR **S21** FLANGE

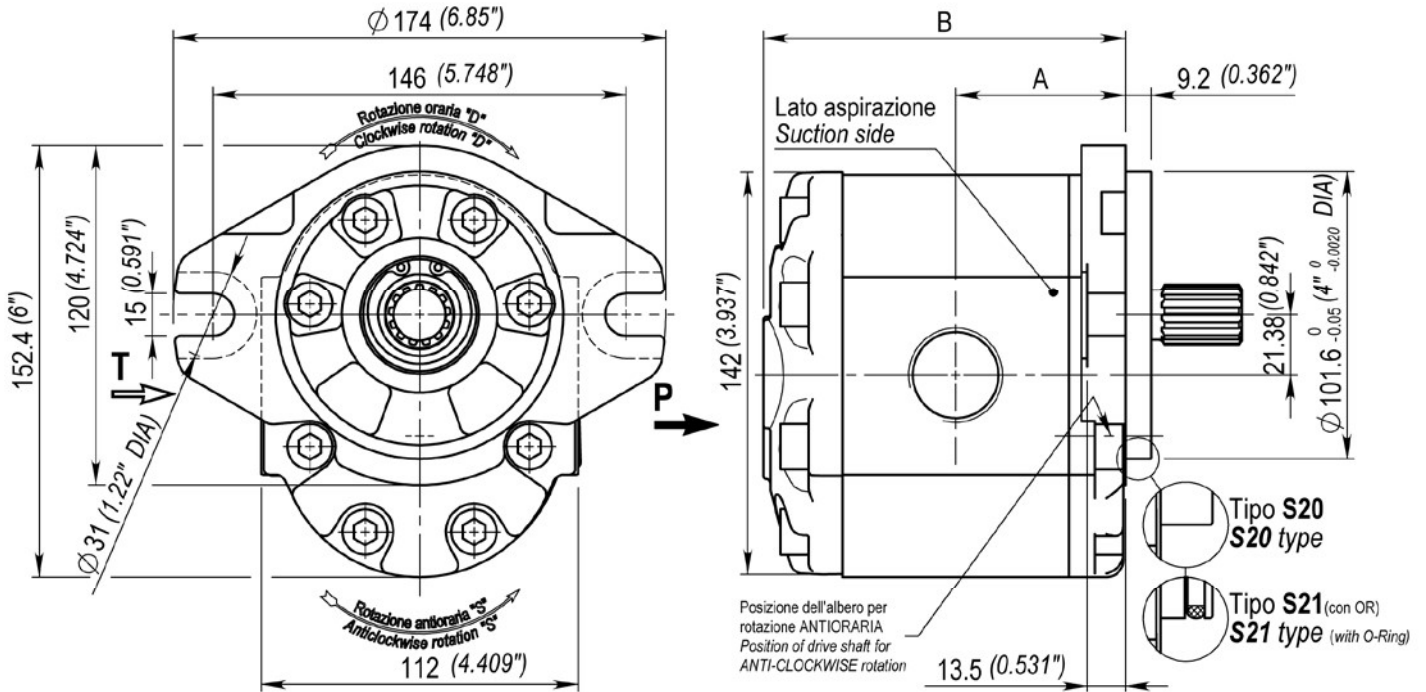

## DIMENSIONI E PESI - EXTERNAL DIMENSIONS AND WEIGHTS

Grandezza Size	Cilindrata cm <sup>3</sup> /giro Displacement (in <sup>3</sup> /rev)	Pressione max di esercizio Max working pressure			Dimensioni Dimensions		Massa kg Mass (lbs)
		P1 Bar (psi)	P2 Bar (psi)	P3 Bar (psi)	A mm (in)	B mm (in)	
BG30-19	19.05 (1.22)	250 (3625)	270 (3916)	300 (4351)	60.2 (2.37)	128 (5.04)	4.98 (11)
BG30-22	22.2 (1.42)	240 (3481)	260 (3771)	290 (4206)	61.5 (2.42)	130.8 (5.15)	5.10 (11.3)
BG30-28	28.3 (1.82)	220 (3191)	240 (3481)	260 (3771)	64.1 (2.52)	136 (5.35)	5.34 (11.8)
BG30-33	33.2 (2.13)	220 (3191)	230 (3336)	260 (3771)	66.2 (2.60)	140.1 (5.52)	5.52 (12.2)
BG30-37	37.2 (2.38)	210 (3046)	230 (3336)	250 (3625)	67.9 (2.67)	143.5 (5.65)	5.68 (12.5)
BG30-44	43.98 (2.82)	200 (2901)	220 (3191)	240 (3481)	70.8 (2.79)	149.3 (5.88)	5.93 (13.1)
BG30-52	51.9 (3.33)	200 (2901)	210 (3046)	230 (3336)	74.1 (2.92)	156 (6.14)	6.24 (13.8)
BG30-61	61.4 (3.94)	180 (2611)	190 (2756)	200 (2901)	78.2 (3.08)	164.1 (6.46)	6.60 (14.6)

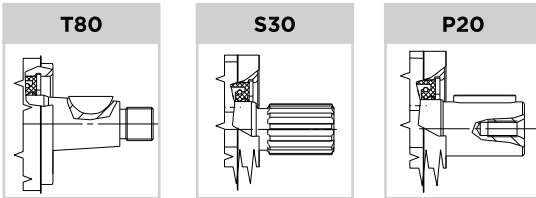
**ALBERI CONSIGLIATI - SUGGESTED SHAFTS**

Vedi dimensioni a fine sezione BG30  
See dimensions at the end of section BG30

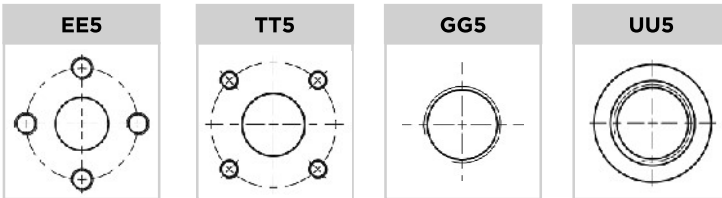
**CONNESSIONI DISPONIBILI - SAVALIABLE CONNECTIONS**

Vedi dimensioni a fine sezione BG30  
See dimensions at the end of section BG30

"X" = numero variabile dipendente dalla cilindrata  
"X" = variable number that depends on the displacement

**CODICE ORDINAZIONE - ORDERING CODE**

<b>BG30</b>	CODICE CODE	
	CILINDRATA DISPLACEMENT	<b>19</b> <b>22</b> <b>28</b> <b>33</b> <b>37</b> <b>44</b> <b>52</b> <b>61</b> 19.05 22.2 28.3 33.2 37.2 43.98 51.9 61.4
	FLANGIA FLANGE	<b>S20</b> Standard Standard
	FLANGIA E COPERCHIO FLANGE AND COVER	<b>A</b> Alluminio Aluminium <b>G</b> Ghisa Cast iron (Heavy duty)
	ALBERO SHAFT	<b>T80</b> <b>S30</b> <b>P20</b>
	CONNESSIONE CONNECTION	<b>EE5</b> <b>TT5</b> <b>GG5</b> <b>UU5</b>
	ROTAZIONE ROTATION	<b>D</b> Rotazione destra Clockwise rotation <b>S</b> Rotazione sinistra Anticlockwise rotation
	COPERCHIO STANDARD STANDARD COVER	<b>O</b> Standard Standard
	GUARNIZIONI SEALS	<b>O</b> Tenute in Nbr Nbr seals <b>V</b> Tenute in Viton® Viton® seals