

7 Displacements 7 Schluckvolumen Cylindrée 7 Despazamientos	(15.3 to 61.0 in ³ /rev) 250 . . . 1000 cm³/rev	
Maximum Pressure Eingangsdruck Pression entrée Pressione in entrata	Cont. (3500 psid) . . . 241 bar	Int. (4500 psid) . . . 310 bar
Maximum Oil Flow Schluckstrom Débit d'huile Portata	(60 gpm) . . . 227 lpm	
Maximum Speed Drehzahl Velocità di rotazione Vitesse de rotation	(523 rpm) 523 rpm	
Maximum Torque MaxDrehmoment Couple Coppia	Cont. (21360 lb in) 2413 Nm	Int. (23540 lb in) 2660 Nm
Maximum Side Load at Key Seitenlast Charges latérales Carico radiale	(5900 lb) . . . 26245 N	

Exceptional Strength and Durability in a High Performance Motor

The heart of Parker's TK Series powertrain, the torque link, is an extra heavy duty part that includes patented 60:40 spline geometry. Rugged construction throughout allows the transmission of over 23,000 lb-in of torque. The entire powertrain is continually washed in cool, high flow fluid to assure long life. Roller vanes and sealed commutator maintain high efficiency and provide smooth low speed performance.

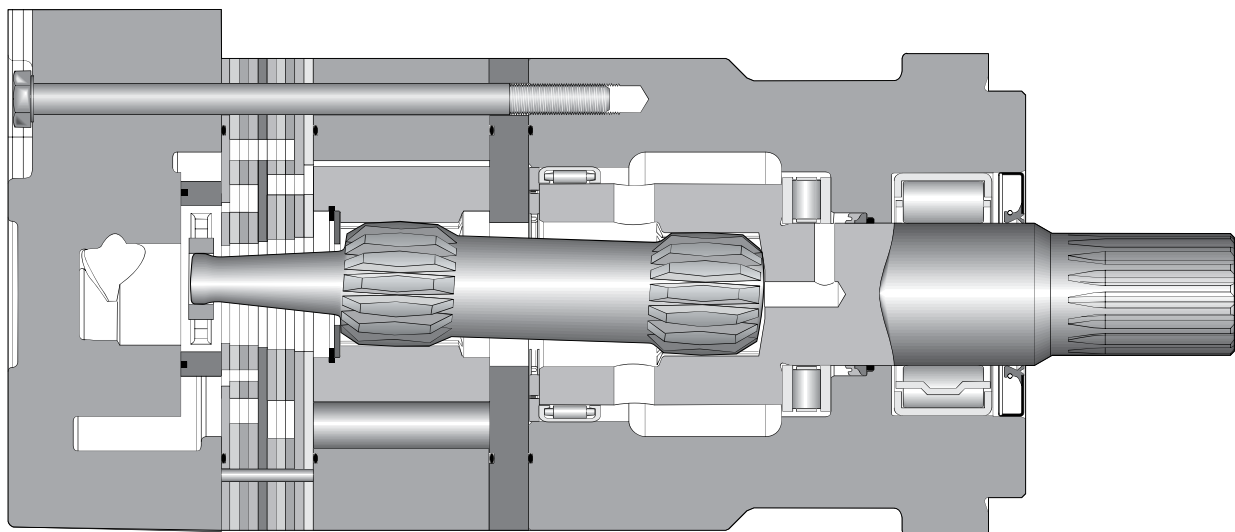

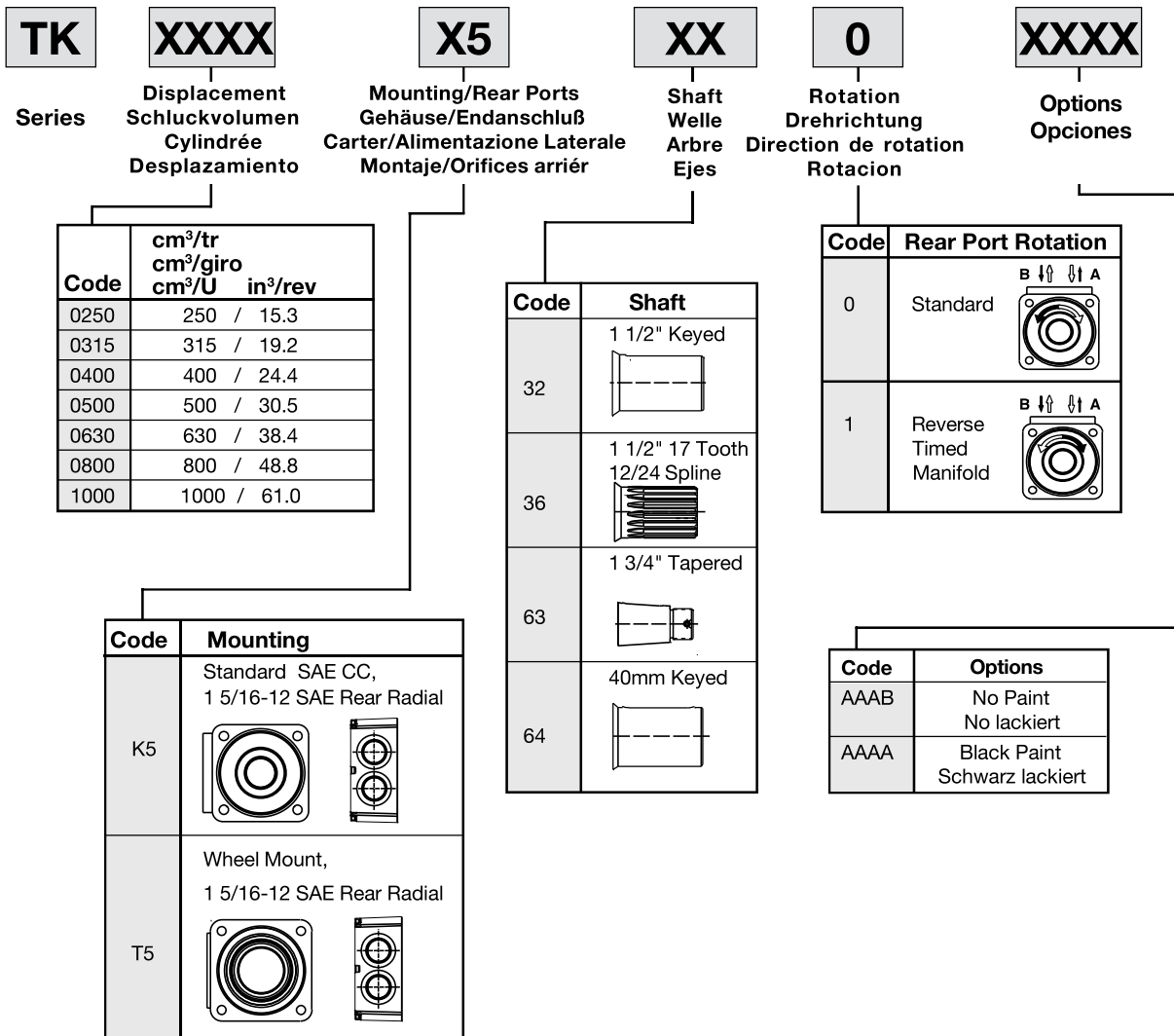

For other available options, see pages 257–258.

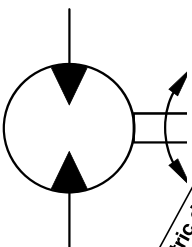

Motor Series TK	cm ³ /rev in ³ /rev	rev/min	cont / int* l/min g/min	cont / int* bar psid	max bar psig	cont / int* Nm lb-in	max KW HP	cont / int* Nm lb-in
TK 0250	250 15.3	523	114 133 30 35	241 310 3500 4500	328 4750	814 1043 7204 9234	48.5 65.0	689 879 6100 7780
TK 0315	315 19.2	413	114 133 30 35	241 310 3500 4500	328 4750	1029 1314 9105 11625	47.4 63.5	949 1217 8400 10770
TK 0400	400 24.4	373	114 151 30 40	207 276 3000 4000	328 4750	1153 1524 10201 13484	48.7 65.3	1049 1410 9280 12480
TK 0500	500 30.5	298	114 151 30 40	207 276 3000 4000	328 4750	1439 1914 12736 16940	48.1 64.5	1322 1783 11700 15780
TK 0630	630 38.4	237	114 151 30 40	207 224 3000 3250	328 4750	1617 1716 14313 15187	33.7 45.2	1497 1621 13250 14350
TK 0800	800 48.8	276	151 227 40 60	190 207 2750 3000	328 4750	1916 2300 16960 20360	44.4 59.5	1745 1902 15440 16834
TK 1000	1000 61.0	218	151 227 40 60	172 190 2500 2750	328 4750	2413 2660 21360 23540	35.4 47.5	1981 2180 17535 19290

Performance data based on testing using 10W40 oil with a viscosity of 200 SUS at 54° C (130° F) Performance data is typical. Actual data may vary slightly from one production motor to another.

Les donnees sur les performances sont basees sur des tests utilisant de l'huile 10W40 d'une viscosite de 200 SUS a 54°C (130°F). Ces donnees correspondent a des situations typiques. Les donnees reelles peuvent varier legerement d'un moteur de production a l'autre.

Leistungsdaten sind gemessen mit SAE 10W40 bei einer Viskosität von 43,1 Cst bei 54°C. Geringfügige Abweichungen von den Katalogdaten sind möglich.

Datos tecnicos obtenidos con aceite 10W40 de 200 SUS de viscosidad a 54°C (130°F). Los datos proporcionados son valores tipicos. Los valores exactos reales podrian tener una pequena variacion entre distintos motores.

* Intermittent operation rating applies to 10% of every minute.
Intermittierende Werte maximal 10% von jeder Betriebsminute.
Fonctionnement interm. 10% max. de chaque minute d'utilisation.
Capacidad de funcionamiento intermitente valida para 10% por cada minuto.